

1-048 Quarter-Turn L13.5

Tool operable, Install with fastening clip, Optional pre-assembly



Product Notes:

- Components can be pre-assembled by DIRAK upon request
- Pre-assembled Quarter-Turn can be installed in cutout
- Max. IP54
- RH and LH application

Material:

- **Housing:** PA, Black or Zinc Die, Chrome Plated
- **Fastening clip:** Steel, Zinc Plated
- **Grounding clip:** Stainless Steel
- **Insert:** Zinc Die, Chrome Plated or Black or combination of PA, Black/ Zinc Die
- **Screw and wave washer:** Steel, Zinc Plated
- **Key:** Zinc Die
- **Cam:** Steel, Zinc Plated

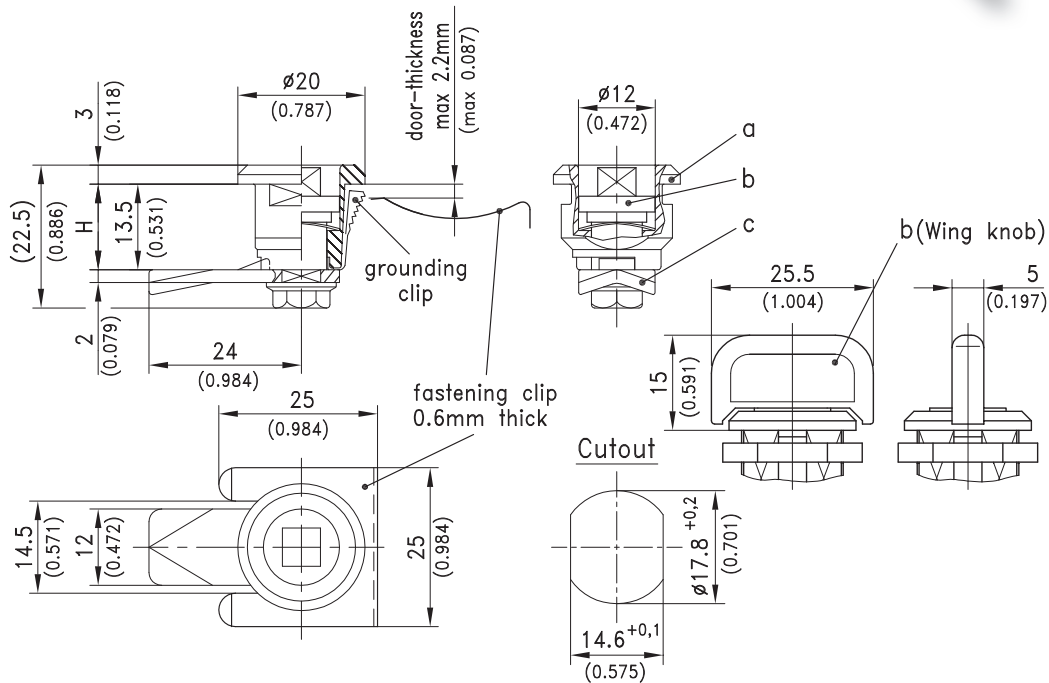

a) Housing	PA Black	Zinc Die Chrome Plated	See Page	
RH with fastening clip	220-9501	220-9013	01.10	
RH with fastening clip and grounding clip	220-9503	220-9007		
NOTE: On LH doors the opening direction is clockwise				
b) Insert	PA, Black and Zinc Die	Zinc Die Chrome Plated	Zinc Die Black	Key (Zinc Die)
With screw and wave washer				
Triangular 6.5mm	-	220-9101	220-9104	204-0112
Square 6mm	-	220-9102	220-9105	204-0111
Slotted 1.5mm	-	220-9103	220-9106	-
Socket hex. 4mm (5/32")	-	220-9118	220-9119	-
Socket hex. 6mm	-	220-9107	-	-
Wing Knob, PA black/Zinc Die*	220-9117	-	-	-
c) Cam	Steel, Zinc Plated			
H = 7.5mm	220-0503	220-0503	220-0503	
H = 13.5mm	220-0501	220-0501	220-0501	
H = 19.5mm	220-0502	220-0502	220-0502	
Special cams				01.100
Optional:				
d) Assembling without O-ring	220-0001	220-0001	220-0001	
* Assembling to b) cam 90° to wing knob without O-ring	220-0006	-	-	